

NOTES

- (1) No concrete in trough area or secondary conduit area. Locate secondary conduits in secondary conduit area as shown.
- (2) Guard posts are required in traffic area.
- (3) Concrete pad shall be 3000PSI concrete, level within +/- 1/4" in 5' and trowel finished to provide a true plane within 1/16" in 5' as determined by a 5' straight edge.
- (5) Bring conduits up flush with pad.
- (6) Contact engineer for conduit orientation and configuration:
 - (a) For PNM direct buried primary system, customer shall install PVC elbows and PVC stubouts.
 - (b) For PNM Primary conduit system, customer shall install rigid elbows with concrete encased PVC stubouts or concrete encased elbows with concrete encased PVC stubouts.
- (7) Minimum of 1'10" x 14" to be maintained for secondary duct area to allow up to 8 - 4" secondary duct.
- (8) Existing grade and backfill under concrete pad shall be compacted to 95% in accordance with ASTM D1557.
- (9) All secondary cables must be tagged with phase and address for tracing reasons. The secondary cables shall be marked no more than 12" above the conduits.

REFERENCES

- (1) See DS-7-16.1 Guard Post
- (2) See DS-7-16.8 Page 1 and 2 Transformer and Switchgear Pad Foundation Preparation and Inspection
- (3) See DS-7-16.12 Minimum Working Space and Fire Safety Requirements for Transformers

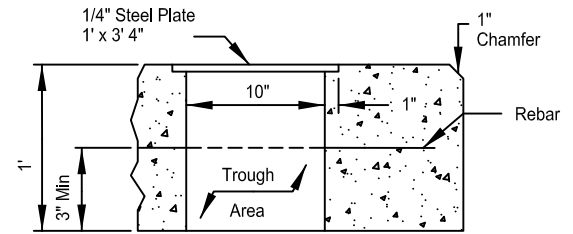

Section B-B